

Töush  
Inspired by Pensonic

SMART ROBOTIC VACUUM  
T9001SRV

Instruction Manual

Before operating this appliance, please read these instructions completely.

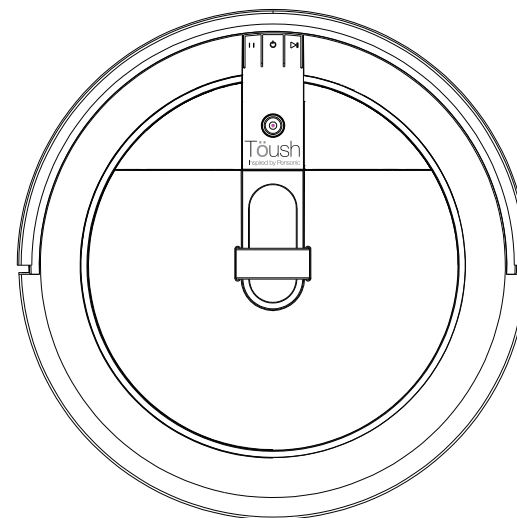

## Contents

## Page

Parts introduction 02

Technical specifications 07

Before the first use 08

How to use this Smart Robotic Vacuum 11

Cleaning and maintenance 19

Troubleshooting 26

Important guidelines 27

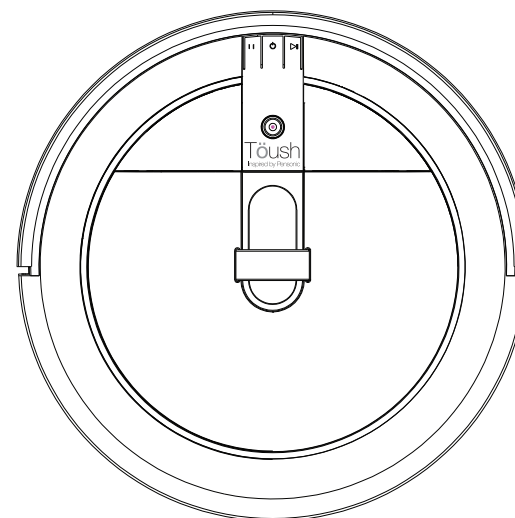

Thank you for choosing TÖUSH products.  
We hope you have an enjoyable experience using our products.

## PARTS INTRODUCTION

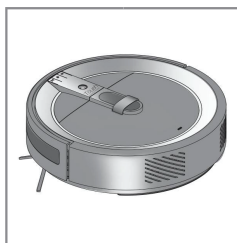

**Host**

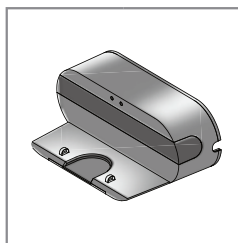

**Charging Station**

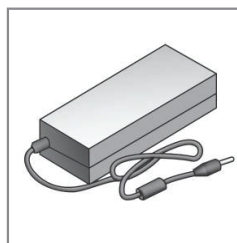

**Charger**



**Power Cord**

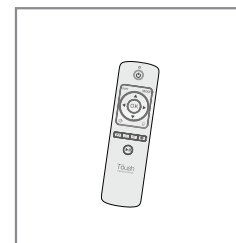

**Remote Control**



**1 unit of side brush**

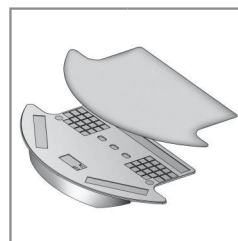

**Water tank with  
mopping pad**

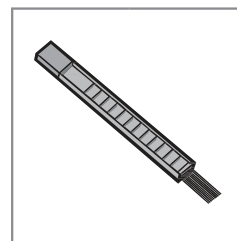

**Cleaning brush**

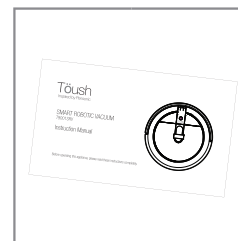

**Instruction manual**



## PRODUCT PARTS

- 1. Display screen
- 2. Digital camera
- 3. Dustbin cover

- 4. Anti-collision buffer component
- 5. Internal anti-collision sensors

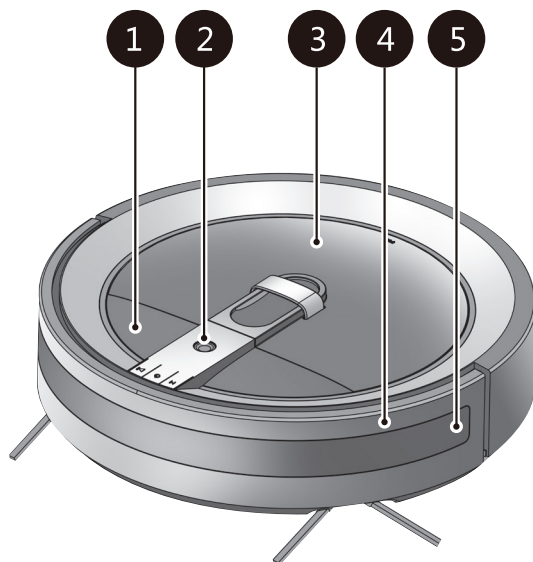

- 6. Air outlet
- 7. Power adapter hub
- 8. Power switch

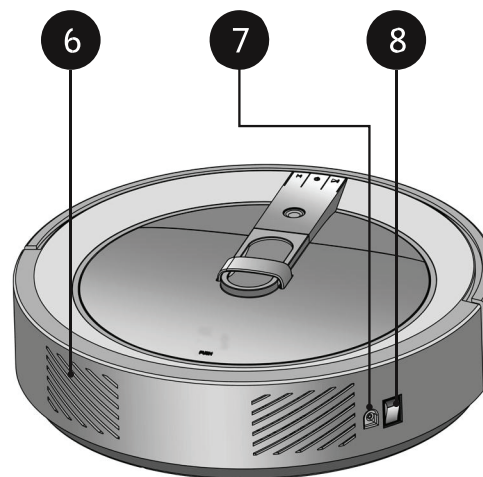



### CONTROL PANEL GUIDE Smart Robotic Vacuum (Top View)

1. Scheduled cleaning
2. High/Low climbing
3. Wet mopping
4. Mode
5. Power
6. On/Pause
7. Silent mode
8. Recharge
9. Error
10. Dust indicator
11. Wifi
12. Spot cleaning
13. Cleaning navigation
14. Time
15. Battery

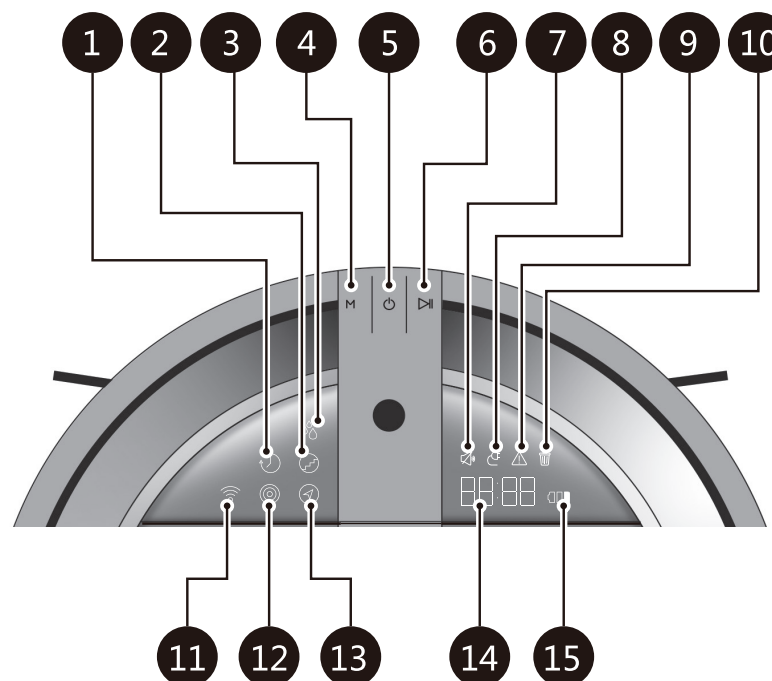





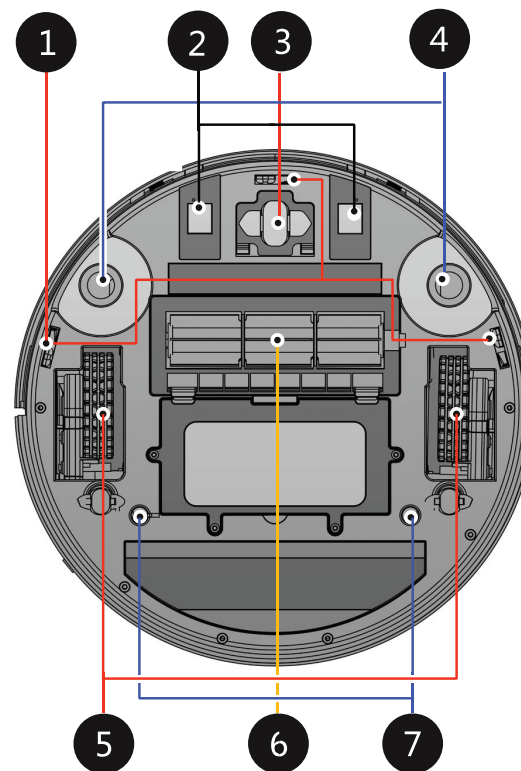





### CONTROL PANEL GUIDE Smart Robotic Vacuum (Bottom View)

1. Anti-falling sensors
2. Charging metal contact pieces
3. Front wheel
4. Side brushes installation positions
5. Side wheels
6. Central brush and suction input
7. Water tank installation position



## REMOTE CONTROL GUIDE

1.  Power On/Off. If the product stops, press this button and it will continue operating based on the last set function.
2.  Connects to WiFi.
3. **MODE** Cleaning mode: To select preferred cleaning mode.
4.  Direction buttons: In manual cleaning, it moves the product forward, backward, rotate left and right.
5. **OK** 'OK': Press this button to confirm the selected mode.
6.  Silent: Turns on/off the audio instructions.
7.  On/Off indicator light: To indicate the product is operating.
8.  Time: To set the current time.
9.  Scheduled cleaning: For product to begin operating at a scheduled time.
10.  Recharge: Press this for product to return to charger.
11.  Suction adjustment: This is to adjust the suction power from 50% to 100%.
12.  Start/Stop: Press this to start or stop the product. The default mode is navigation cleaning with high climbing.

06

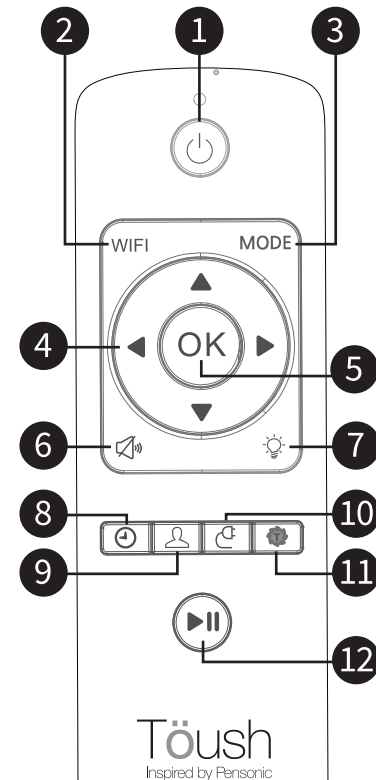

### PRODUCT FEATURES:

- Intelligent camera system captures images, maps and updates house or residence's room routes.
- Group of 24 sensors and three ARM (Advanced RISC Machine) smart chips explores and creates the most optimal cleaning path.
- Covers up to 98% of cleaning area and 30%-50% more cleaning efficiency than other normal vacuums operating in the same environment. No need to worry about obstacles such as furniture on the floor. Simply turn it on, and let it do the cleaning for you.

### SMART NAVIGATION SYSTEM:

- Visual Localization
- Optimal cleaning path
- Auto Recharge
- APP
- Spot Cleaning
- Virtual Wall
- Climb over obstacles
- Smart navigation
- Smart scenario light
- Adjustable suction power
- Anti-winding
- Voice function
- Scheduled cleaning
- High-quality gyros chip
- Anti-falling
- Anti-collision

### TECHNICAL SPECIFICATIONS

Model	T9001SRV
Voltage	100-240V
Frequency	50/60Hz
Size	Diameter 348mm x Height 96mm
Battery	Lithium battery 14.4V 2600mAh
Dustbin capacity	700ml
Water tank capacity	120ml

### BEFORE THE FIRST USE

#### Charging Station Installation

- Ensure the area around charging station is clear of obstruction (2 meters in front, 1 meter on the left and 1 meter on the right of the charging station).
- Install the charger in a location where it can be easily accessed by the product.
- Arrange the power cord along the wall.
- Always keep the power cord of the charger plugged into the power outlet.
- If no power is supplied to the charger, the product will not be able to find the charger and will not be able to charge automatically.
- If the product is separated from the charger, the battery is automatically discharged.

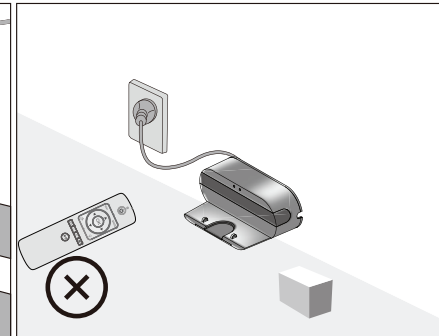
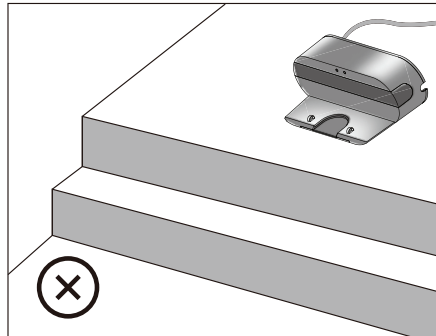
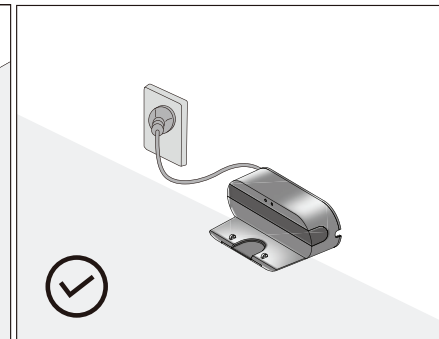
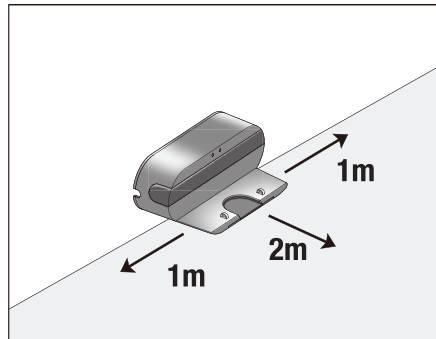

### Installation of Side Brushes

- When assembling the brush, fit the 'L' mark on the edge-cleaning side rotating brush to the 'L' mark on the main unit on the left side of the product. Do the same for the right or 'R' rotating brush.

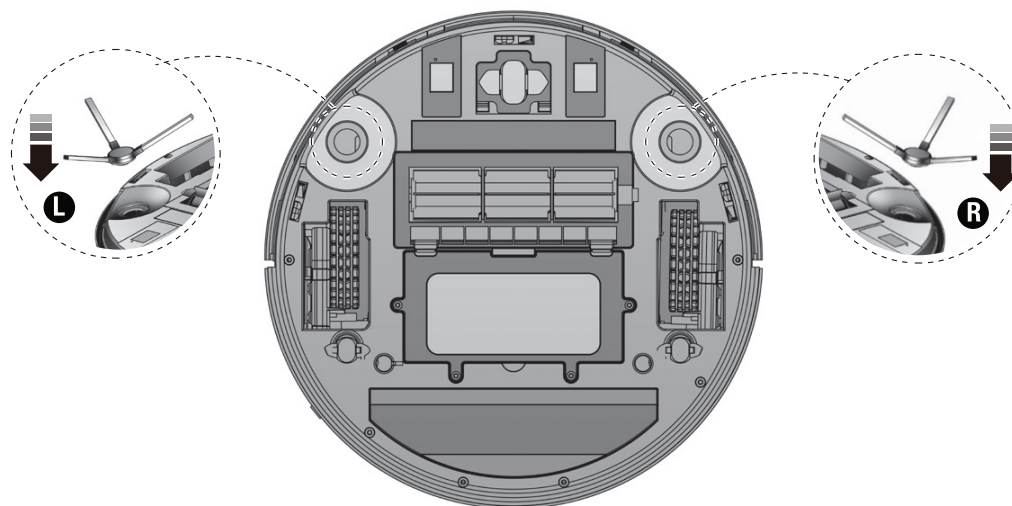

## CHARGING MANUALLY

After the charging station and brushes installations are done, charge the product before using it for the first time.

1. Turn on the power switch on the side of the host.
2. Lift the host and put it on the charging station. Place host properly on the charging station. When the red indicator light is on, it starts charging.

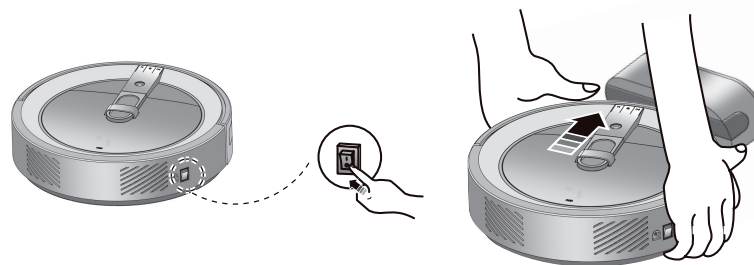

3. The product is ready to use once it is fully charged. It takes about 4 hours for it to be fully charged. Product can be used for 90 minutes under normal vacuuming condition. The actual operating time depends on the home environment.

Battery indicator 	Fully charged	The light is fully lit and flashes once every second.
	Low battery	Light flashes once every second.

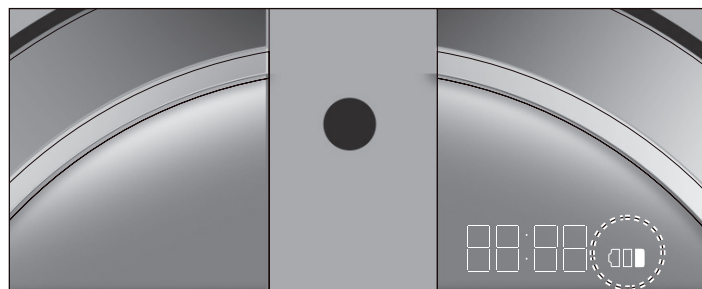

4. The host can be recharged manually without the charging station.

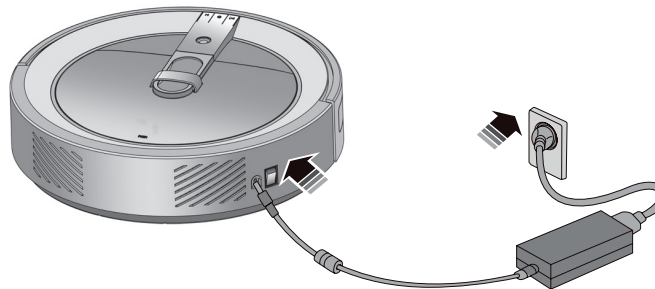

#### HOW TO USE THIS SMART ROBOTIC VACUUM

1. Remove all obstacles from the floor before the cleaning begins. Materials with wool or similar materials may prevent the product from performing the cleaning, so please remove it.
2. The product cannot clean properly if the dustbin is full, therefore please check after each cleaning and empty it. Please refer to section under **Cleaning Dustbin** on how to clean it.
3. Please remove anything that is obstructing the anti-falling sensor or wheels for the product to function properly. Please refer to section under **Cleaning Sensors**.
4. Avoid places where the product may fall over or narrow places like desks, tables or shoe cabinets as the product may identify shoes or other articles as floor and may fall.



## CLEANING

1. Turn on the power switch.
2. Press the power on button of the product or on the remote control.
3. Start cleaning. The default mode is navigation with high climbing. When using this mode, please remove the water tank under the device to make it suitable for floor and carpet cleaning.
4. Let the product begin cleaning from the charging station and return to the charging station after cleaning is done.

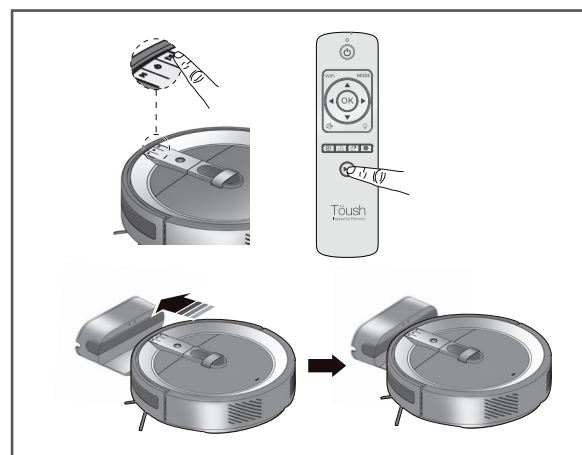
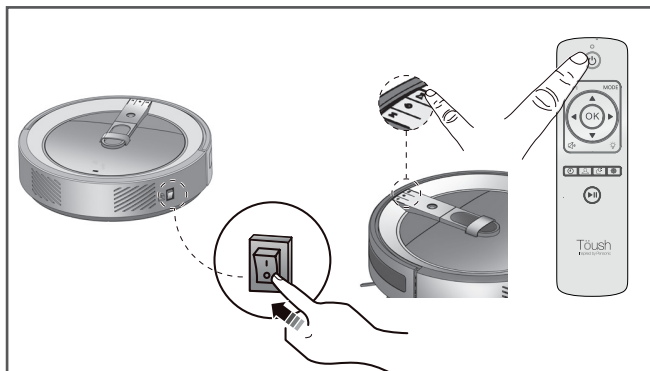

5. Press the start/stop button on the product to start cleaning.
6. Stop cleaning when cleaning is completed. Once cleaning is completed, the product will return to its charging station immediately.
7. The product may not go through a threshold which is higher than 1cm.

## CHANGING DIFFERENT CLEANING MODES

After the charging station and brushes installations are done, charge the product before using it for the first time.

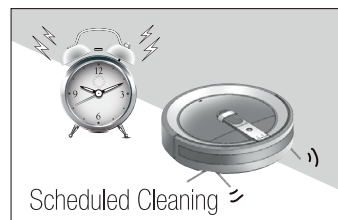
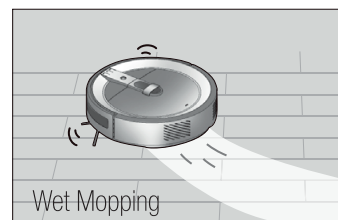
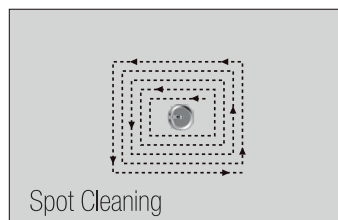
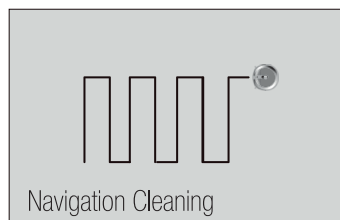

Users can select different cleaning modes according to the environment. Press the 'M' button on the top of the product, or press the 'MODE' button on the the remote control to change the cleaning modes.

## WET MOPPING

1. When the water tank is installed in the product, the cleaning mode will change to Wet Mopping automatically.
2. The default setting of Wet Mopping is navigation with low-climbing. Please remove obstructions such as carpets or floor coverings.
3. If the Wet Mopping is used on a carpet, the carpet may be damaged.
4. Put water in water tank. Install the mopping pad on the water tank. Keep mopping pad a bit wet. A too wet or completely dry mopping pad will affect the mobility of the product.
5. Switch off host and install wet mopping pad at the bottom of the product.

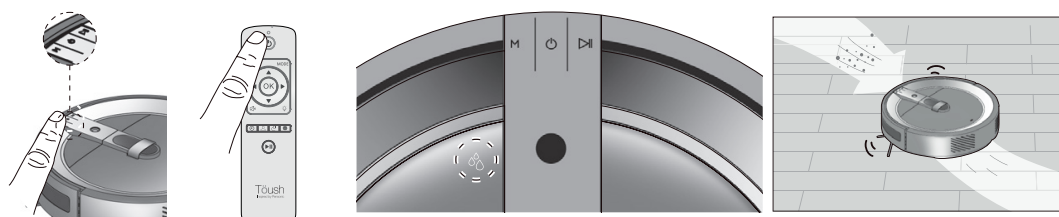
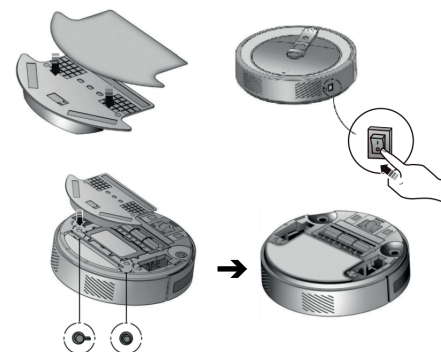

6. Switch on the host and place it back to start from the charging station.
7. Press the power on button and start/stop button at the top of the product or on the remote control to start cleaning. The mode indicator will be shown on the screen.

## SPOT CLEANING

The product will take the current position as the center to intensively clean 1 square meter of space from the centre point.

1. Turn on the power switch.
2. Press the power button on, the start/stop button on the product or on the remote control.
3. Press 'M' to choose spot cleaning mode. The mode indicator will be displayed on the screen.



4. The product should not be placed on the charging station to start the spot cleaning mode.  
After the cleaning is finished under spot cleaning mode, the product will stop right there.
5. If there are too many obstacles, the product may not be able to carry out the cleaning normally.

## MANUAL CLEANING

1. Switch on host.  
Press the power button.

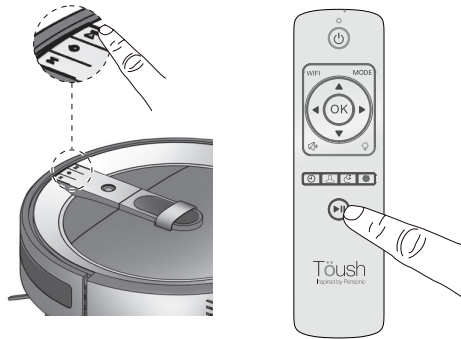

2. Use the arrow buttons on the remote control to steer the product according to the direction you desire.
3. Manual operation can be done only when the product is not connected to charging station.

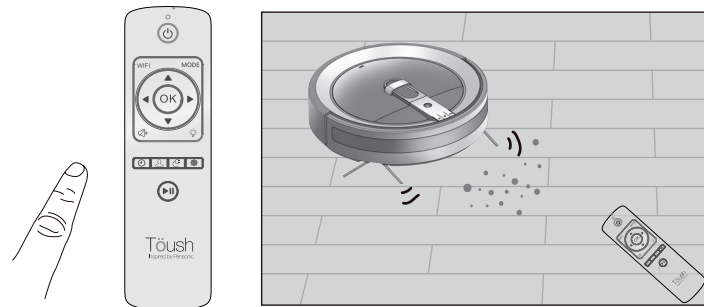

### **TIME/SCHEDULE SETTINGS**

1. This product has scheduled cleaning function. You can use the remote control to schedule it to clean at any time. Before using the scheduled cleaning function, please set the system time first.
2. This function cannot be set when the product is charging.

### **SET CURRENT TIME**

1. Set current date and time by pressing 'Time' button on the remote control. The time number will change to 'A:1', and keeps blinking.
2. Press '▲▼' button to shift from 1 to 7. The figure 1 to 7 represents Monday to Sunday.
3. Press 'OK' to save the current date and enter the current hour and minute.
4. Time is set according to 24-hour system. Set the hour first. Press '◀▶' button ◀ 'to increase and ▶' to decrease the hour. Press 'OK' to set the hour. Press '▲▼' to shift between hours and minutes. After setting the minutes, press 'OK'. Now the numbers on the screen will be back to date setting.

### **SCHEDULED CLEANING SETTINGS**

1. To schedule date settings, press 'Schedule' button on the remote control. The time number will change to 'H1:OF', and keep blinking.
2. Press button to shift from H1 to H7 which represents Monday to Sunday. Press 'OK' to save the current date setting.

3. Press '▲▼' button to shift from 'OF' to 'ON'. 'OF' represents OFF, while 'ON' represents ON. Press 'OK' to make sure the setting is at ON/OFF. When the setting is at 'ON', press 'OK' to set the time. Schedule cleaning hour and minute settings. Time is set according to 24-hour system. Set the hour first. Press '◀▶' button ◀ 'to increase and ▶' to decrease the hour. Press 'OK' to set the hour. Press '▲▼' to shift between hours and minutes. After setting the minutes, press 'OK'. Now the numbers on the screen will be back to date setting.
4. To finish settings, press 'Schedule' button on the remote control again to exit the setting menu. The mode indicator will be shown on the product's display screen.
5. To cancel the set schedule, go to 'Schedule' mode and cancel the setting.

### SUCTION POWER ADJUSTMENT

1. The suction power can be adjusted using the remote control according to different cleaning requirements.
2. Press 'turbo' button on the remote control to adjust the suction power. The battery's life will be reduced and the operating sound will increase due to the powerful turbo suction mode.

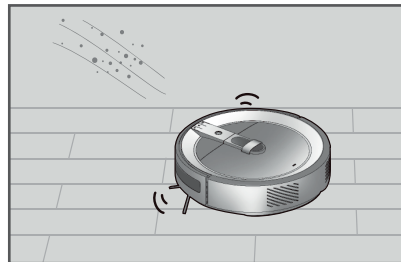
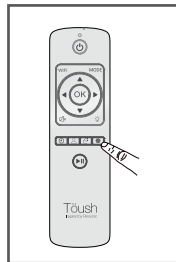

## CLEANING AND MAINTENANCE

### Cleaning Dustbin

1. Press lightly on the 'PUSH' labelled position on the dustbin cover.
2. Open the cover.
3. Take the dustbin out.
4. Empty the dustbin.
5. Put the dustbin back in its original position.
6. Press the 'PUSH' position to ensure the cover is closed.

Note: You can empty the dustbin after each cleaning, or empty it according to alerts of the dust full indicator. The cleaning effect will be reduced if the dustbin is not cleaned on time.

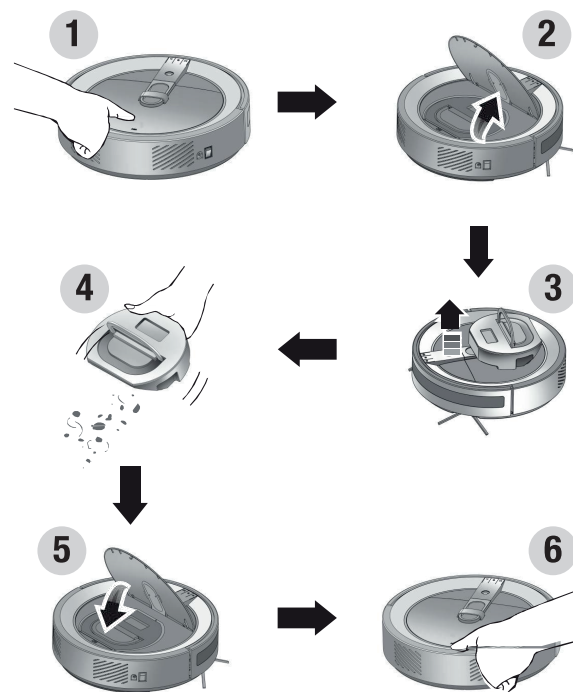



### Changing the Dustbin Filter

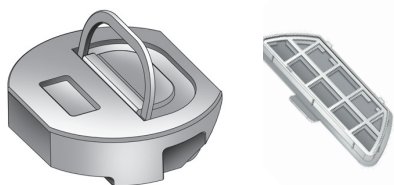

1. Change the filter immediately when there are cracks or holes on the filter.
2. In a normal environment, the filter life is two months. The actual filter life depends on the environment. If the filter is not changed on time, the suction power will be less powerful. This filter cannot be washed.

### Cleaning the Suction Inlet

1. Open the cover.

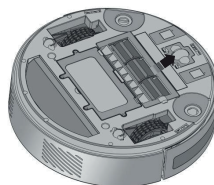
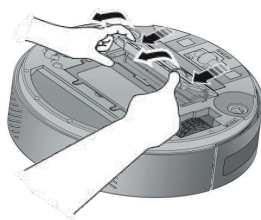

2. Remove the main brush.

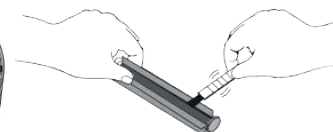
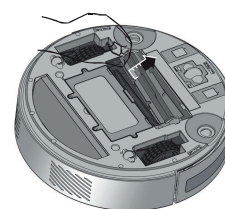

## **CLEANING THE SENSORS AND WHEELS**

### **Cleaning the Sensors**

1. Use the provided cleaning brush or cotton bud to clean the three anti-falling sensors shown in the picture.
2. If they are very dirty, please use a damp cotton bud to clean them.
3. Please do not pour water directly, or use benzene or alcohol to clean it.

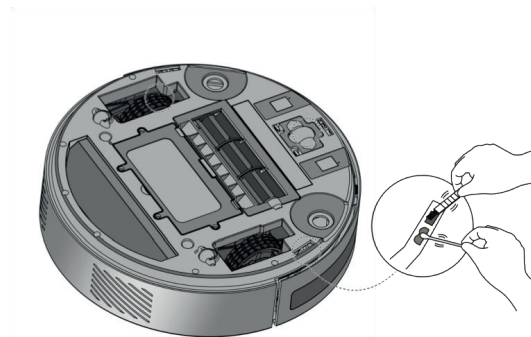

### **Cleaning the Front and Side Wheels**

1. Turn the side wheels around manually while cleaning them with the cleaning brush or cotton cloth.
2. Use cleaning brush to clean the front wheel.
3. Please remove any dirt such as hair that has wound itself around the wheels.

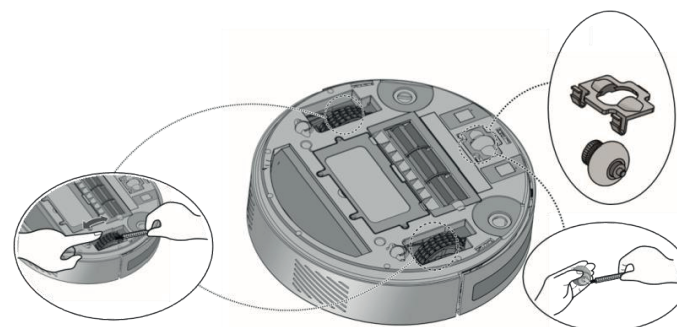

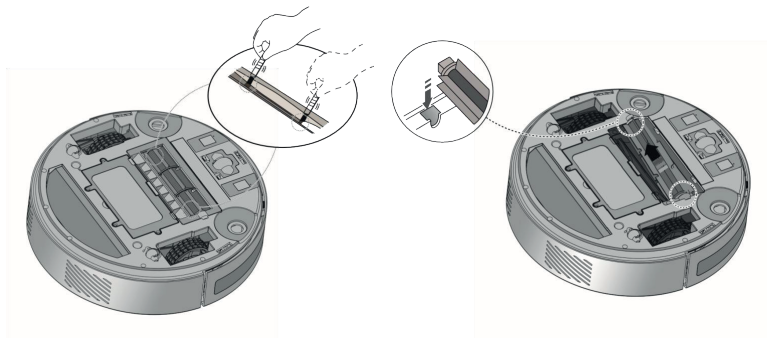

- Use the cleaning brush or cotton bud to clean the two dust sensors. If the dust sensors are very dirty, please use damp cotton bud to clean them. Please do not pour water directly, or use benzene or alcohol to clean it.

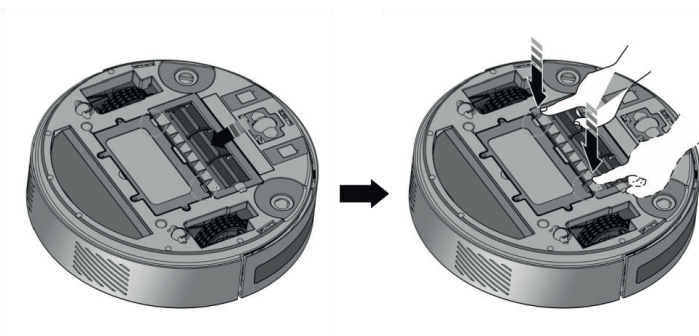

- Fix the main brush and suction inlet cover, and ensure they are in the correct position.

## BATTERY MANAGEMENT

Long term use will shorten the product's battery life.

- The battery life in a normal environment is 6 months.
- To have the best battery performance, please charge the battery fully before every use.
- The battery life may vary according to different environments.
- If the product is not used for a long time, please turn off the power switch.
- Please clean the suction inlet, dustbin, main brush, side brushes and wheels frequently.
- If the dustbin is full, the product's internal motor will be overloaded and this will shorten the battery life.
- When charging and storing the cleaner, please avoid exposure to sunlight, fire or smoke.
- When using the product for the first time, please charge it fully before using.
- The charging takes about 4 hours.
- After fully charged, the product can usually be used for 90 minutes.
- If powerful turbo suction mode is used, the surroundings are too complicated or too dusty, the battery usage time may be reduced to less than 45 minutes.
- Please change the batteries if the operation time has reduced.
- Ensure the new batteries have the same specifications as the original ones. New batteries are available at the Pensonic Customer Care Centre.

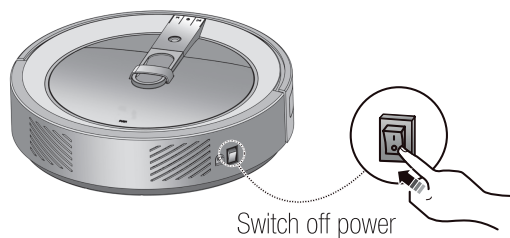

- Switch off power before changing the battery.
- Make sure the old batteries are disposed properly according to the local authority disposal regulations.
- If you are not sure about how to change the battery, please contact Pensonic Customer Care Centre.
- Turn off the power switch on the side of the product.
- Remove the screws (4) from the battery cover and remove the battery cover.
- Disassemble the power line connection of the battery and remove the battery.

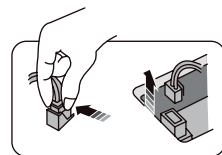
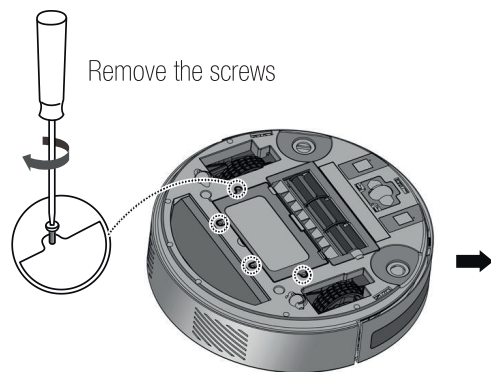

Disassemble the power line connection

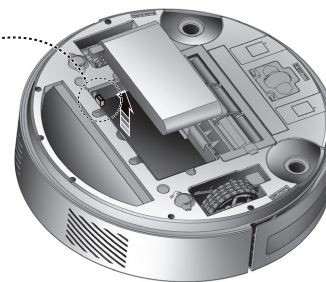

## VOICE PROMPT MESSAGES

The Voice Prompt Messages list is a list of basic audio notifications and they may vary according to the model and cleaning modes.

Message	Function
Content of the instructions	Working status
Auto-cleaning is proceeding	Start navigation cleaning as default mode
Spot mode is proceeding	Start spot-cleaning mode
Stop cleaning	Stop the current cleaning mode
Switch to turbo mode	The suction power is adjusted to the maximum
Start to charge	Start charging
Switch to wet-mopping mode	When the water tank is installed, it operates on wet-mopping mode automatically
Cleaning completed	Cleaning operation is finished
Enter schedule mode	Start schedule settings
The schedule has been set	Complete schedule settings
Return to charging station	Start the function of recharging

## TROUBLESHOOTING

Note: If the problems cannot be solved after troubleshooting, please contact Pensonic Customer Care Centre.

Error Codes	Possible Causes	Symptoms	Solutions
E001	The dustbin is full or the inlet is blocked.	The host does not operate as usual.	Empty the dustbin and clean the inlet.
E002	Middle brush faults.	There may be items wound around the middle brush.	Remove the items wound around the middle brush and restart the cleaning mode.
E003	The dustbin not fixed properly.	The host unable to operate.	Fix the dustbin properly.
E004	Left or right wheels do not touch the floor.	Left or right wheels do not touch the floor.	Put host on a smooth and level floor, and restart the cleaning mode.
E005	Left or right wheel faults.	There may be items wound around the left or right wheels.	Remove the items wound around the wheels and restart the cleaning mode.
E006	Anti-falling sensors do not work properly.	The sensor is blocked or the host is blocked at the stairs.	Check and clean the anti-falling sensors or move host to restart the cleaning mode.
E007	Left or right side brush faults.	There may be items wound around the left or right brushes.	Remove the items wound around the brushes and restart the cleaning mode.
E008	Front wheel fault.	There may be items wound around the front wheel.	Remove the items wound around front wheel and restart the cleaning mode.
E009	Power switch not turned on.	The host unable to start operating.	Turn on the power switch.



### IMPORTANT GUIDELINES

Please read these instructions carefully before using this product and keep them for future reference.

- Place product on a dry, level, stable and firm surface. Do not install charger in humid place.
- Do not place product in a place directly exposed to sunlight to prevent over heating resulting in damage to charger, electric shock, short circuit or fire.
- Ensure the product voltage rate matches the voltage stated on the rating label.
- Please keep the charging station plugged in all the time to ensure the product can recharge automatically. Do not use charger to charge any other electrical items other than this product.
- Ensure there are no small objects or fragile items scattered on the area to be vacuumed such as toys, magazines, shoes or socks before cleaning.
- Clear any objects before cleaning especially fragile items such as china or glass objects.
- This product does not recognise coins or valuable items such as jewellery.
- Remove bath towels, mats near wet areas, entrance and utility rooms.
- Move away power cords, table cloths or any dangling objects out of the product's way to prevent them from becoming entangled in the product's wheel or brush, causing damage to the product.
- Do not use the product charger to charge other electronic products to prevent damaging the charger or the connected device. Using damaged parts or products will increase risk of fire.
- Do not use damaged cord or plug.
- Please do not use or keep the product together with combustible materials or can cause combustion such as alcohol, gasoline, kerosene and diluents, cigarettes, candles and heaters to prevent fire.





### IMPORTANT GUIDELINES

- If there is any abnormal noise, burning smell or smoke from the product, please turn off the power immediately and contact Personic Customer Care Center.
- Please do not climb or sit on the product whether the product is stationary or moving as this may cause personal injuries or product damage.
- Please do not use the product on a narrow or high place, such as on a table to prevent product from being damaged or getting personal injuries due to falls.
- Do not use the cleaner to suck or go through water, oil, or pet excrement to prevent damage to product. If the wheels or brushes are contaminated, it will contaminate other places.
- During operation, immediately remove any plastic bags that are sucked by product. If the dust suction port is blocked, the internal motor will run for a long time resulting in high temperature that will cause product damage.
- Do not press or kick on the anti-collision buffer component which is located on the front side of the product as this will damage the collision buffer sensor component, leading to incorrect operation.
- Do not keep or use product in a temperature that is too low ( $\leq -5^{\circ}\text{C}$ ) or too high ( $\geq 35^{\circ}\text{C}$ ) as this may damage the product.
- Empty the dustbin when full. Operating product when the dustbin is full may result in reduced suction power.
- Do not operate dustbin without filter as this may damage the product.
- Do cleaning and regular maintenance to prevent foreign bodies such as hair from sticking to the main brush or the side brushes. This may cause noise, reduction in suction power or product damage.
- Please do not use product on mirror or glass floor as this product uses infrared sensors which may not be able to identify glass or mirror as obstacles.



### IMPORTANT GUIDELINES

- Do not use product on wet floor, shaggy carpet, stairs, tables, shelves, and in other large commercial or outdoor areas.
- Always clean the product after the power is turned off. Cleaning the product while it is on may result in personal injuries and product damage.
- Always clean the main brush, the dustbin, side brushes, filters and suction inlets after use to ensure they are in good working condition.
- If the product or the parts are damaged, please contact Pensonic Customer Care Centre.
- As for places that doesn't need cleaning, please close the door or use the virtual magnetic strip to tell the product where not to go (optional for some models).
- During cleaning, please do not drag or move the product manually because it may cancel the set cleaning path in its memory or result in incomplete cleaning.
- The product must begin cleaning from the charger station, because the product will take the starting point as its start/stop coordinates when it finishes cleaning or goes back for charging.
- Charge the product manually at least an hour before using when it is used for the first time (refer to details under section **Manual Charging**).
- Check whether the dustbin is full immediately after cleaning is completed. If dustbin is full, please empty it. A full dustbin will reduce performance of product. The dustbin must be emptied immediately when the dust indicator light is on.
- This product is intended for household use only.
- Place product on a level, stable and firm surface.
- Do not share single power outlet with multiple electrical products. Before using the product make sure all parts are installed correctly.
- Use only the supplied original accessories that came with the product.



### IMPORTANT GUIDELINES

- To protect against fire, electric shock and injury, do not immerse cord, plug or product in water or other liquid. Do not fix or remove power plug with wet hands.
- Always keep product clean. Ensure all inlets and outlets are free of obstructions.
- The product should always be switched off before connecting or disconnecting from the main socket. Do not pull on the cord to disconnect the plug from the main socket, hold the plug instead.
- Do not let cord hang over edges of tables, countertops or touch any hot surfaces.
- Do not place product near hot surfaces, hot gas or oven.
- Let the product cool down completely before disassembling or putting it away.
- Do not touch product while it is operating.
- Do not leave the operating product unattended.
- Do not use the product outdoors.
- Do not use any attachments or components that were not supplied with this product.
- Always unplug the product after use.
- Do not put any foreign materials into the product.
- Do not submerge the product into water or other liquid or wash it rinse it under running water.
- This product should be used as described within the instructions for use that accompanies it.
- This product is not intended for use by persons (including children) with reduced physical, sensory or mental capabilities, lacking of experience or knowledge, unless they are supervised or instructed concerning the use of the product by a person responsible for their safety.



### IMPORTANT GUIDELINES

- Children should be supervised to ensure that they do not play with the product.
- Keep the product and its cord out of children's reach.
- Do not insert needles, wire and any other metal or foreign objects into the gaps or interior to prevent damage or short circuit.
- Do not operate any product with a damaged cord or plug, or after the product malfunctions or has been damaged in any manner. Any repairs and servicing should always be carried out by PENSONIC Customer Care Centre.



This marking indicates that this product should not be disposed with other household wastes throughout the nation. To prevent possible harm to the environment or human health from uncontrolled waste disposal, recycle it responsibly to promote the sustainable reuse of material resources. To return your used product, please use the return and collection systems or contact the retailer where the product was purchased. They can take this product for environmental safe recycling.

Thank you again for choosing TÖUSH products. Should you require further information/assistance, please visit [www.pensonic.com](http://www.pensonic.com) or write to us at [customerservice@pensonic.com](mailto:customerservice@pensonic.com) or call our toll-free Care Line at 1-800-881-770.

# Töush

Inspired by Pensonic

Distributed By:  
PENSONIC SALES & SERVICE SDN.BHD.  
1165, Lorong Perindustrian Bukit Minyak 16,  
Taman Perindustrian Bukit Minyak,  
14100 Simpang Ampat, Penang, Malaysia.  
Careline : 1800-881-770